

Batch mixing equipment



Deep customisation, bespoke solutions

- Multiple transport options available: trailer-mounted, skid-mounted, or vehicle-mounted.
- Multiple mixing methods available, with manual/automatic options, offering excellent value for money.



Modular configuration, easy to maintain

- The batching and mixing tank, power system, and slurry mixing system employ a modular design for integrated hoisting, facilitating functional expansion.
- Maintenance points are within easy reach, ensuring convenient and efficient operation.

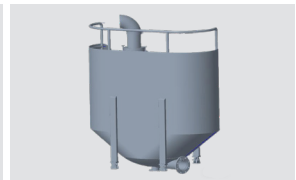
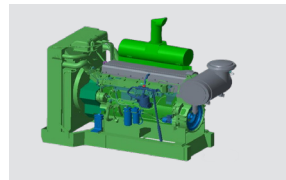

Robust design, dependable and durable

- Core components utilise renowned domestic and international brands, ensuring stable and reliable quality.
- Performance is generous, safety margins are ample, and adaptability is extensive.

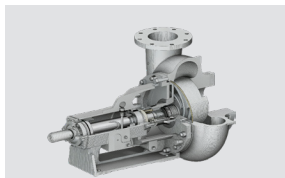

Highly automated, simple to operate

- Lightweight operational logic, tailored to suit diverse user habits, delivers a comfortable experience during extended use.
- Dynamic display of pipeline flow processes, providing a clear overview of pipeline operations.



Parameter Table

Product Name	SYPHT-100/SYPHC-100/SYPHQ-100	SYPHT-150/SYPHC-150/SYPHQ-150
Typical operating conditions	Capable of performing continuous blending, batch mixing, and the preparation of specialised drilling fluids.	
Loading configuration	Vehicle-mounted/Semi-trailer/Skid-mounted	
Chassis	Sany/Beiben/Sinotruk/Semi-trailer	
Engine	Domestic engines (Cummins, Weichai) Imported engines (Caterpillar, Cummins)	
transfer case	Imported transfer cases (Dust transfer case, Spoor transfer case), Domestic transfer cases (Leishida)	
Batch mixing vessel (BBL)	50*2	75*2
Circulating centrifugal pump	6"x5"	
Gravity-fed centrifugal pump	6"x5"	
Maximum discharge pressure in PSI (Mpa)	70(0.48)	
Maximum discharge volume gpm(m3/min)	977 (3.7)	
Density range g/cm3	1.0~2.6	
Mixing method	Simplified Ash-Discharge Hopper / Fitted with High-Energy Mixing System	
Control method	Manual control / Sany density automatic control	
Trailer external dimensions (m)	11.6x2.5x4.0	11.8x2.55x4.15
Total mass of trailer (kg)	20000	22000

Project Cases

